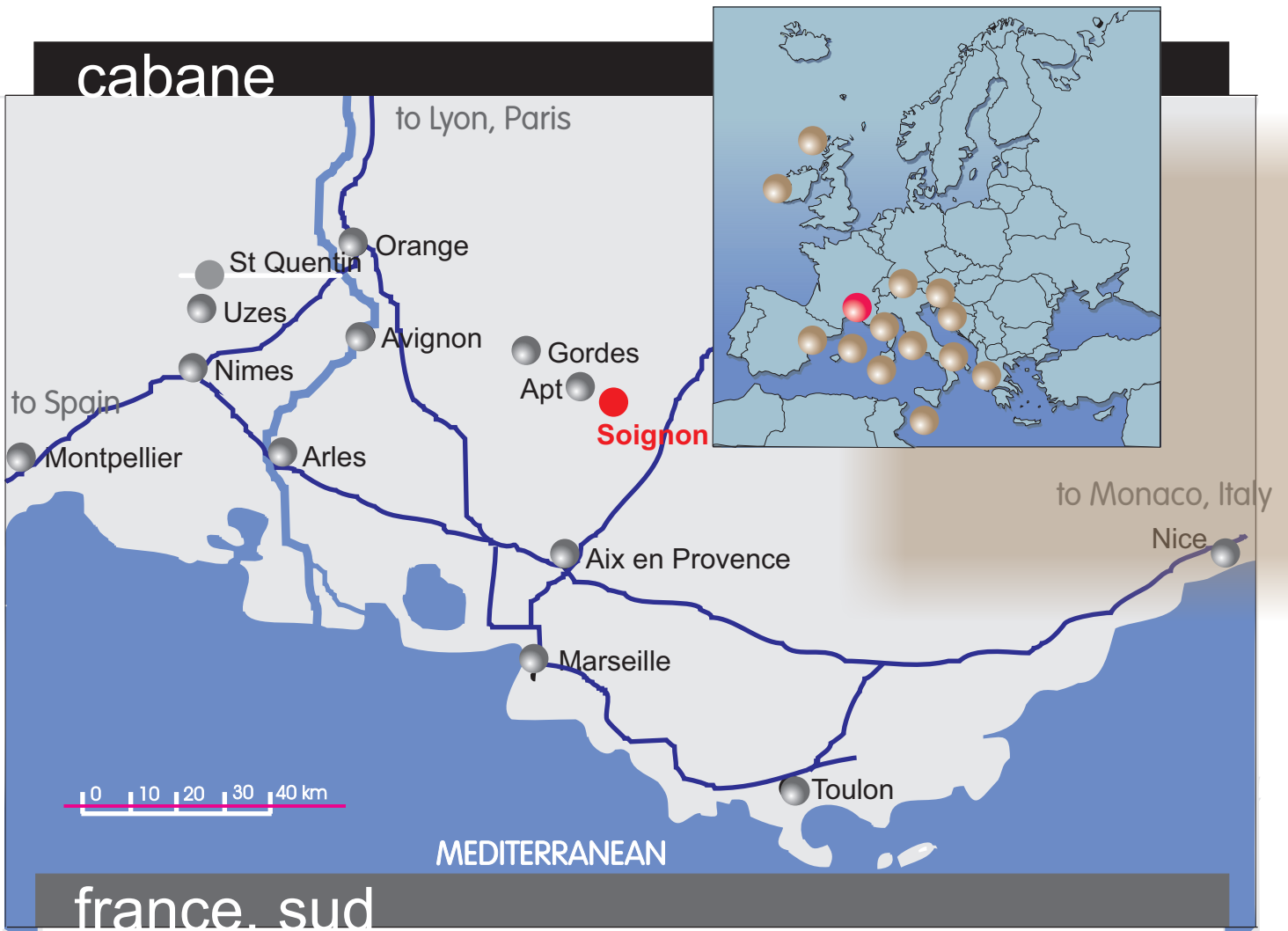

cabane
Soignon, Provence
France

2023

ver. 2301

Borut Juvanec, Institute of Vernacular Architecture, Ljubljana SLOVENIA

cabane



france. sud

Soignon (Provence)

GPS data:
N 43,50.8594
E 5,25.2755
596 m

Cabane is located at the field of lavender, South of Soignon.

It is composed of rectangular base until approximately 2 metres, covered by false dome in corbelling, with a pinnacle on the top.

The entrance is situated toward South, on the East side is the wall in drystone for animals, on the South is waterwell with the depth of 1.65 m (on October 2023, without water). Lavender field is well cultivated, both cabane and waterwell are abandoned, but in technical good state.

October 2023

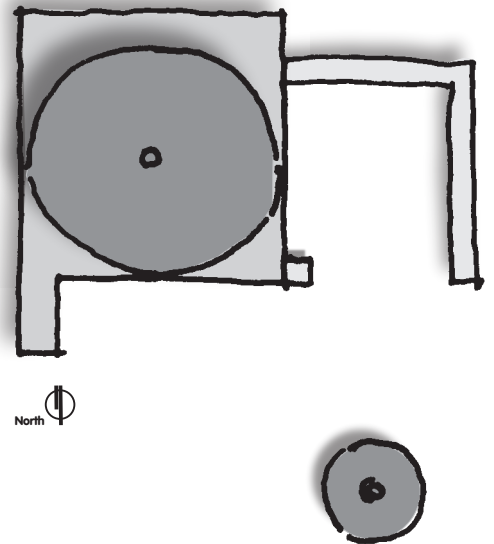

Soignon (Provence)

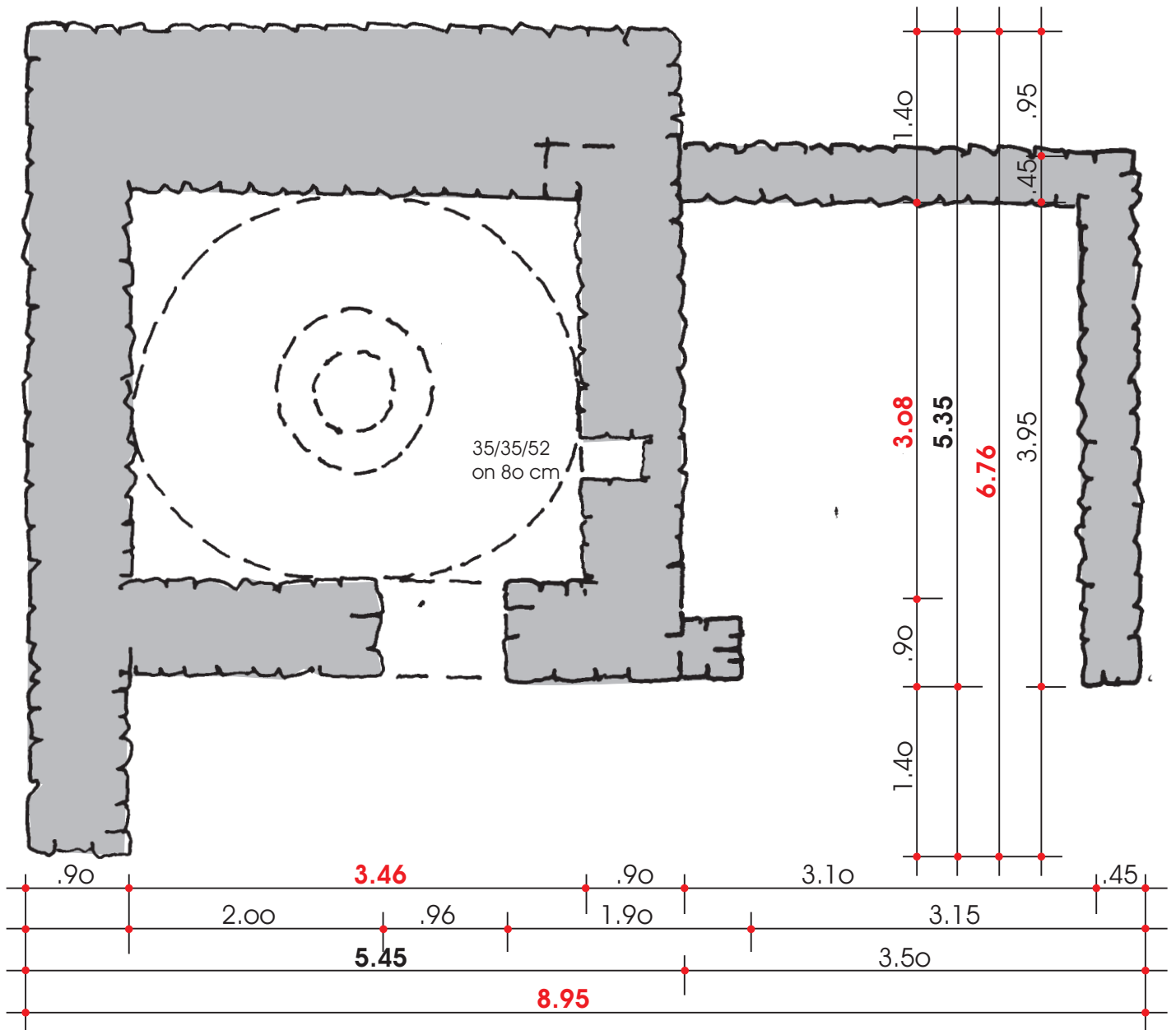

scale 1: 50

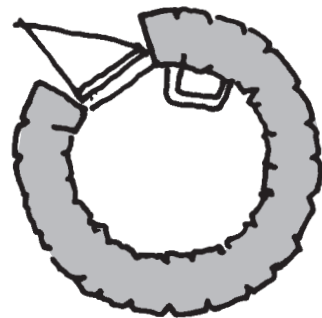

Soignon (Provence)

scale 1: 50

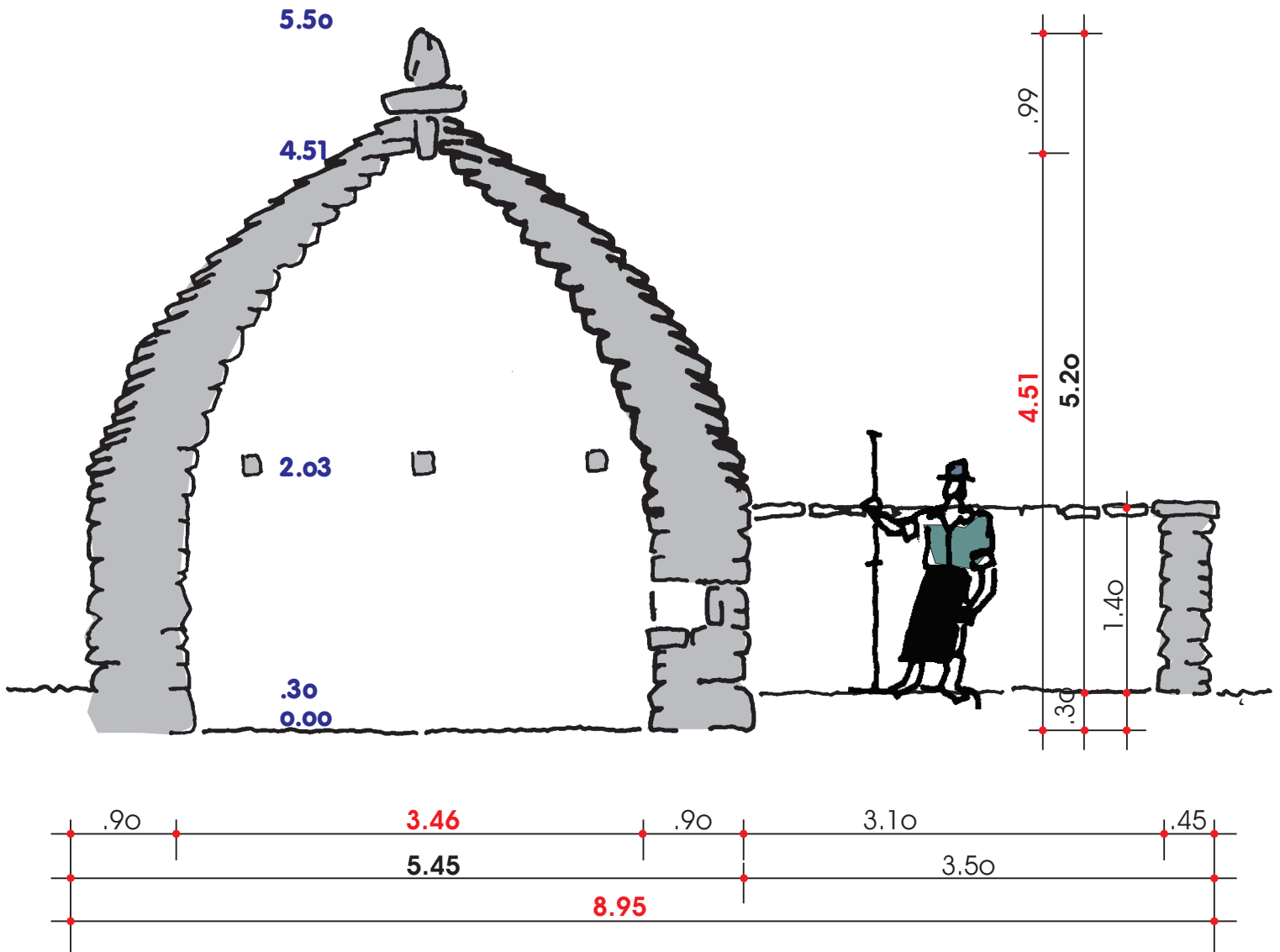

Soignon (Provence)

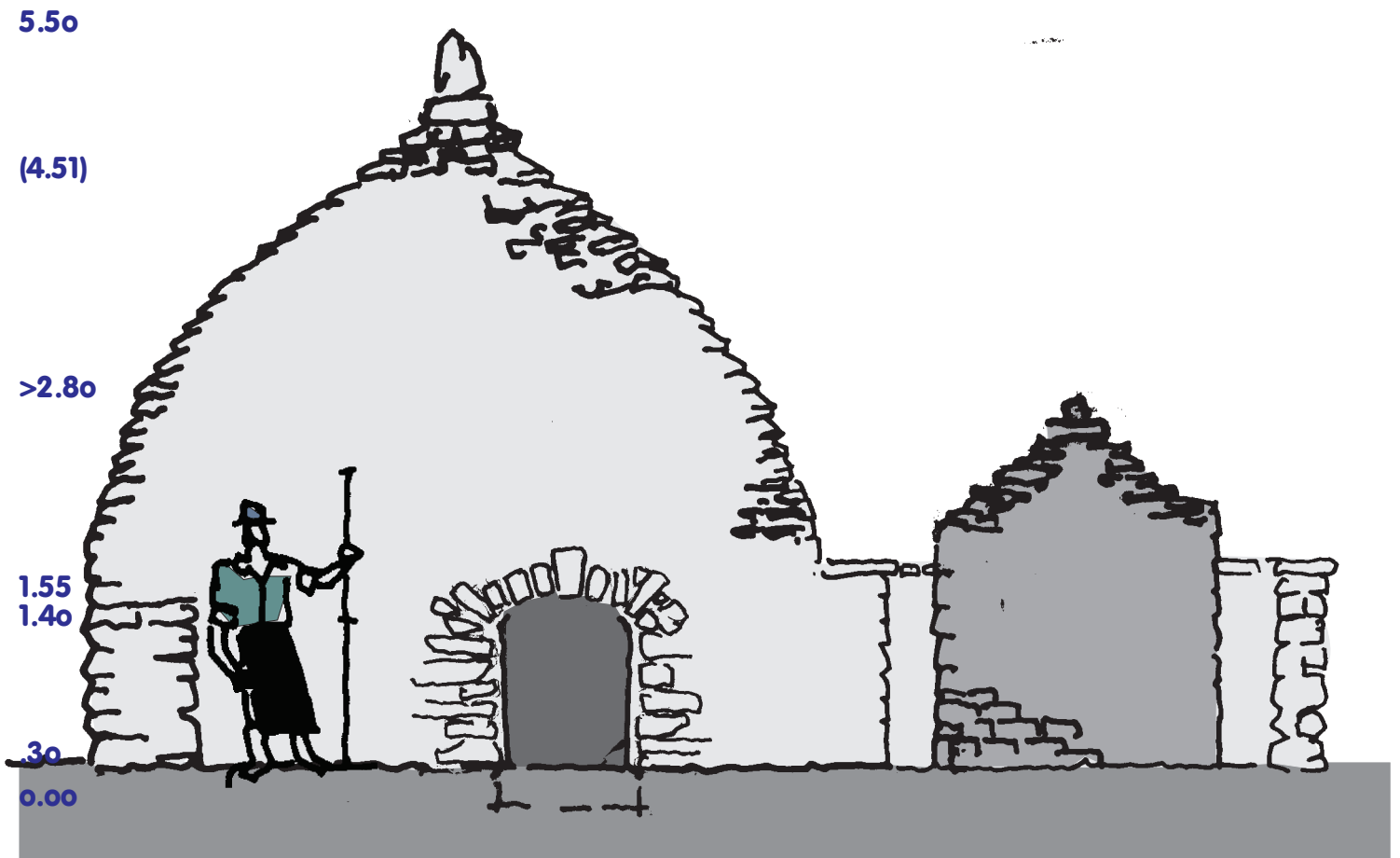

scale 1: 50

Soignon (Provence)



Soignon (Provence)

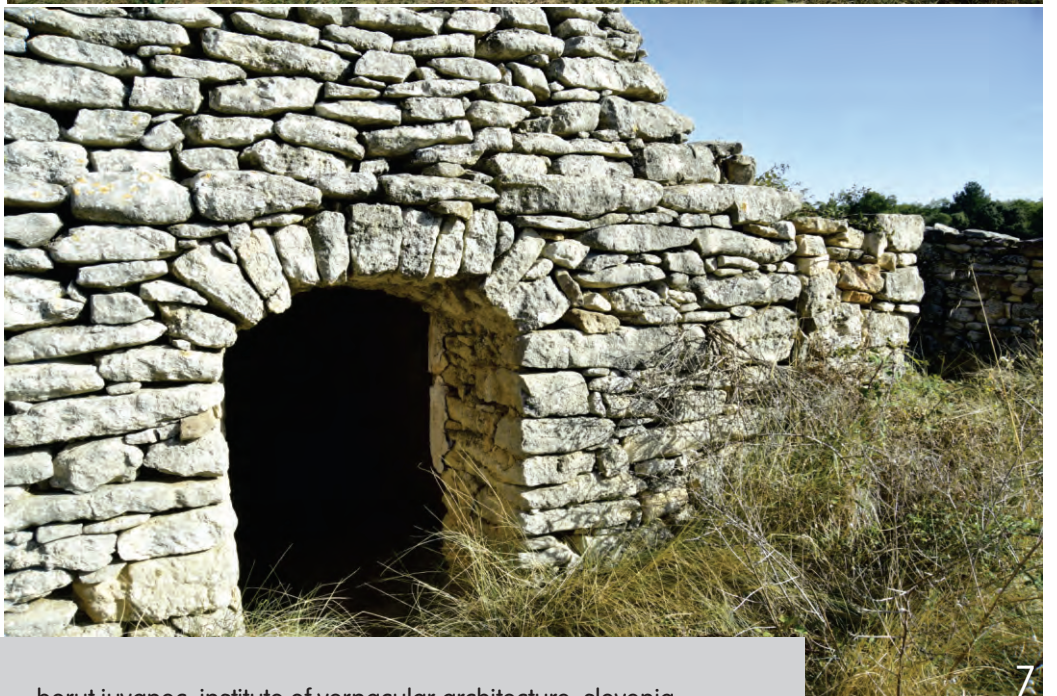

Soignon (Provence)

